

DNAKE



User Manual

DNAKE 725-B&725-FV

REMARK

Please follow the user manual for correct installation and testing. If there is any doubt please call our tech-supporting and customer center.

Our company applies ourselves to reformation and innovation of our products. No extra notice for any change.

The illustration shown here is only for reference. If there is any difference, please take the actual product as the standard. The product and batteries must be handled separately from household waste. When the product reaches the end of service life and needs to be discarded, please contact the local administrative department and put it in the designated collection points in order to avoid the damage to the environment and human health caused by any disposal. We encourage recycling and reusing the material resources.

CATALOG

Product Image And Product List	1
Commissioning Operation	3
Installation Steps	4
Management Setting	5
Product Description	10
Instruction.....	10
APP Setting.....	12

PRODUCT IMAGE AND PRODUCT LIST

1.1 Product Image

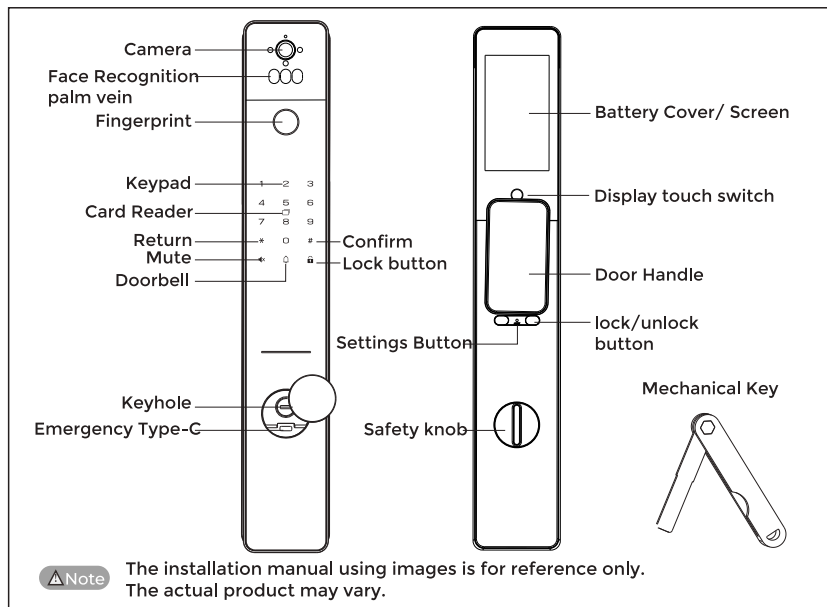

1.2 Product List

After unpacking, please check carefully according to the list, if you find any omissions, please ask us for it in time.

Ref	Name	Quantity
1	Exterior panel(Rubber pad included)	1
2	Interior panel(Rubber pad included)	1
3	Key	2
4	Cylinder	1
5	Proximity Card	2
6	Installation Kits	1
7	User Manual	1
8	Lithium battery	1

1.3 Product Installation Diagram

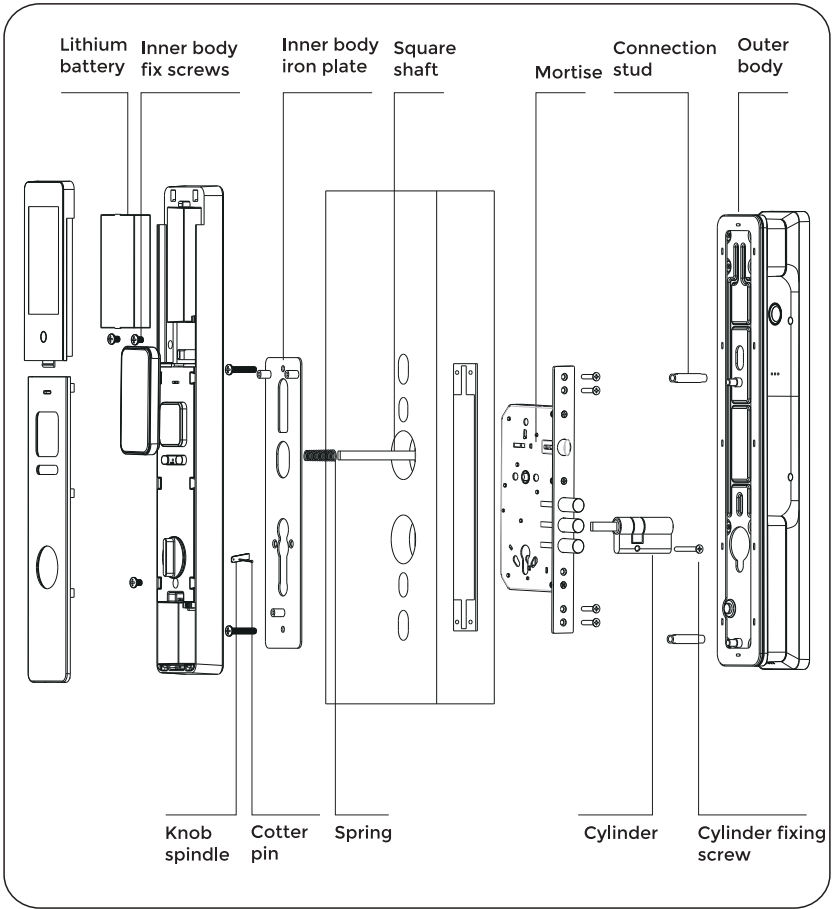

COMMISSIONING OPERATION

2.1 Pre-Operation Instruction

Make sure the smart lock is in the initialization(factory) state before debugging.(Debugging first and management setting second.)



After restoring the factory state, all user registration information will be cleared.



Restore factory state button

2.2 Commissioning Operation Instruction

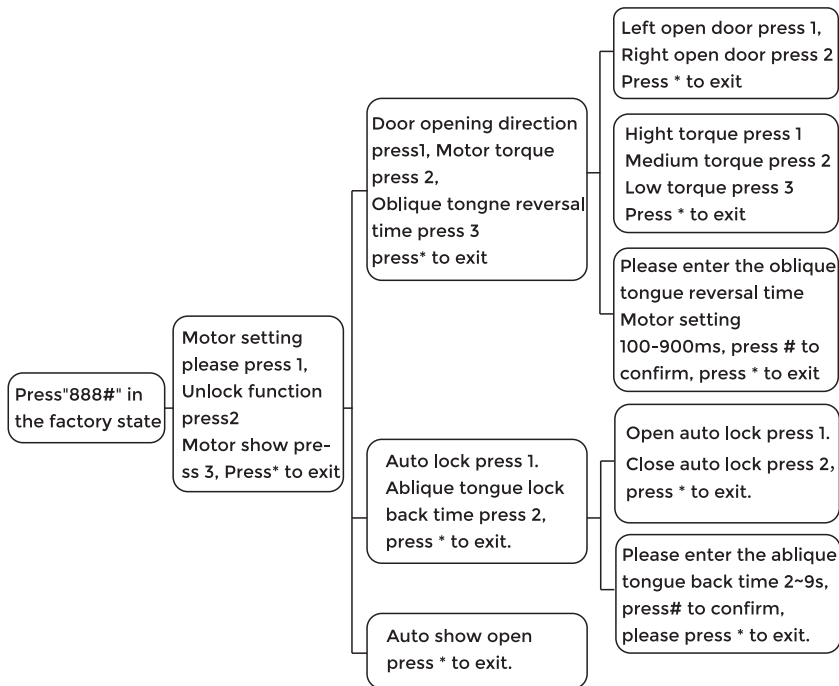

In operation, press * back to the previous menu until you completely exit the setting interface; After administrator registered, press "888#" and administrator to enter the settings, you can also debug.

INSTALLATION STEPS

Parts list:

Square shaft



Slub screw
95mm

Connecting
stud



Slub screw
45mm

Cotter pin



Knob spindle



Cylinder



spring

1. Mortise installation

- Change the direction of the lock tongue according to the direction of door opening.
- Put the lock body into the door body with the opened door hole, and fix it with screws.

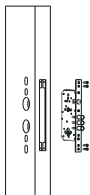

2. Cylinder installation

- Insert the cylinder into the mortise, mark the lock cylinder connecting rod by 7~12mm higher than the inner side of the door, remove the excess part after disassembly, and then fix it with the lock cylinder fixing screw.

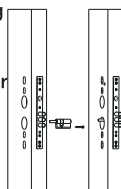

3. Outer body installation

- Tighten the 2 connecting studs to the front panel studs.

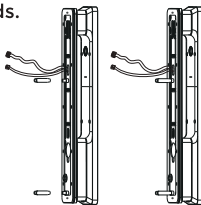

4. Install outer body

- Pass the wire through the top hole
- Insert the lock cylinder head through the panel lock cylinder hole, then press the panel against the outside of the door.

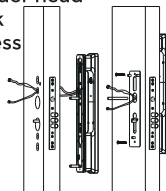

5. Install rear iron plate

- Cut the slub screw to the right length according to the door thickness, attach the rear iron plate to door inside surface and tighten with slub screws.

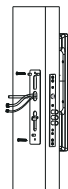

6. Inner body installation

- Connect the wire
- Cut the square shaft to the right size according to the thickness of the door.
- Insert the spring into the square shaft hole on the interior body.
- Cut the knob spindle to the right way, fix it with cotter pin.

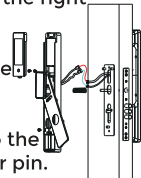

7. Install inner body

- Attach the inner body to the inside of the door and fix it with 3 M4 screws.
- Cover the inner body battery cover.

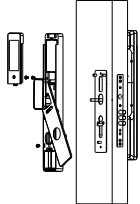

8. Test smart lock

- Operate the inner handle, safety knob mechanical key, and make sure all connected parts is working normally.
- Install the battery and check the function one by one per the manual.

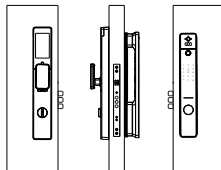

MANAGEMENT SETTING

4.1 How to enter the management setting

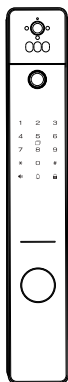

4.1.1 After short touching the keypad to activate the door lock, press "*" # " in turn or short press the set button (on the back panel) once to enter the management setting.

4.1.2 In the factory state, it will automatically enter the administrator password (the number is fixed at 001) registration menu, please refer to the password registration process. If the administrator has already been registered, it will prompt "please authorize"

If the identification of the administrator fails, the voice plays "input error". If the recognition is successful, enter the main menu directly press * to exit, and press the corresponding number to enter the sub - menu.

4.2 Management setting menu

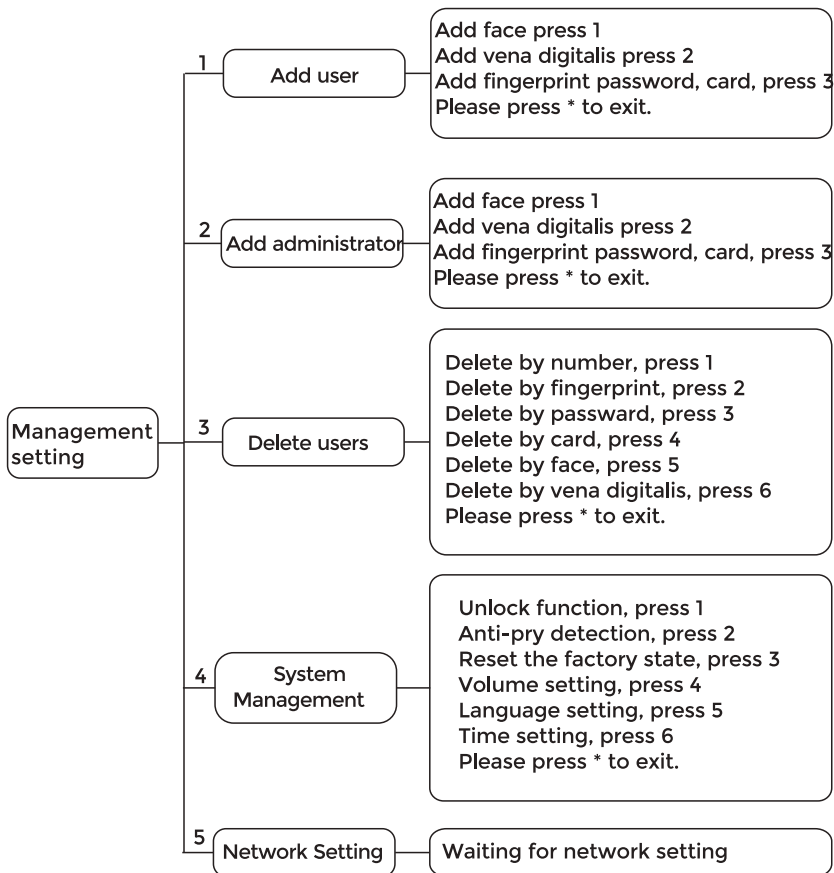

During the above operation, you can follow the voice prompts to operate.

4.3 Add Administrator/User

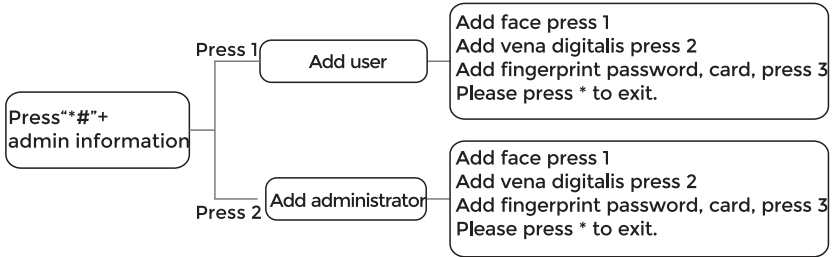

4.3.1 Add face



- Step 1: Enter "Add User" / "Add Administrator".
- Step 2: Select " Add face".
- Step 3: Face the facial recognition area to add the face.

4.3.2 Add palm vein



- Step 1: Enter "Add User" / "Add Administrator".
- Step 2: Select " Add vena digitalis ".
- Step 3: Place your hand over the palm vein recognition area to add the palm vein.

4.3.3 Add finger

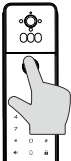

- Step 1: Enter " Add User" / "Add Administrator".
- Step 2: Select " Add fingerprint password, card" .
- Step 3: Press the finger 6 times.

Note

With seasonal environmental changes, there will be deviations in the clarity of fingerprint feature points, resulting in changes in recognition rate. When the recognition rate decreases, customer shall re-enter the corresponding finger.

4.3.4 Add password



- Step 1: Enter " Add User" / "Add Administrator".
- Step 2: Select " Add fingerprint password, card" .
- Step 3: Enter a new 6-12 digits password and #.
- Step 4: Enter the new password again and #.

4.3.5 Add proximity card

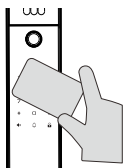

- Step 1: Enter " Add User" / "Add Administrator".
- Step 2: Select " Add fingerprint password, card" .
- Step 3: Enter a new card.

4.4 Delete user

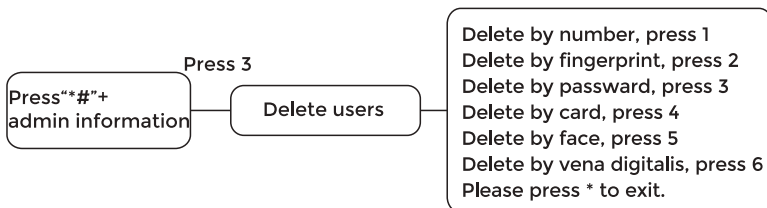

Delete by Number: Administrator number is (001~005), User number is(006~240). Enter the number "XXX" to delete the user/administrator.

Delete by Finger: Verify the enrolled finger to delete the user/administrator.

Delete by Password : Verify the password registered to delete user/administrator.

Delete by Card : Verify the enrolled card to delete the user/administrator

Delete by face: Verify the enrolled face to delete the user/administrator.

Delete by vena digitalis : Verify the enrolled palm vein to delete the user/administrator.

Note If the fingerprint, password or card is not registered, the voice message will play "User does not exist" and skip to the previous step.

4.5 Management Setting

Press**#+
admin information

Press 4

System
Management

Unlock function, press 1
Anti-pry detection, press 2
Reset the factory state, press 3
Volume setting, press 4
Language setting, press 5
Time setting, press 6
Please press * to exit.

4.5.1 System management

Unlock function: (For details, see“4.5.2 Unlock function”).

Anti-pry detection: Open anti-pry detection press 1, Close anti-pry detection press 2, press * to return.

Reset the factory state: press #to confirm, press * to exit.

Volume setting: High volume press 1, medium volume press 2, low volume press 3, press * to return .

Language setting: 1.Chinese 2.English 3.Russian 4.Turkish 5.Arabic

Time setting: Enter the year, month, day, hour, minute, and second according to the voice prompts.

System
Management

Press 1

Unlock function

Passageway, press 1
Auto lock, press 2
Oblique tongue back time, press 3
Body induction press 4
Unlocking mode, press 5
Child lock mode, press 6
Please press * to exit.

4.5.2 Unlock function

Passageway: When enable the function, the door can be opened directly

Auto lock : 1.Open auto lock (3~60s) 2.Close auto lock (Note: if lock use detective mortise, this function will be disabled.)

Oblique tongue back time: 2~9s (Note: if lock use automatic mortise, this function will be disabled.)

Body induction: 1.high sensitivity 2.middle sensitivity 3.low sensitivity 4. Close body induction

Unlocking mode:1.Single verify mode 2.combine mode

Child lock mode: When Child mode is enable, Unlock button/Lock button become invalid.

PRODUCT DESCRIPTION

Finger	capacity:100
Password	capacity:50
Face	capacity:20
Palm Vein	capacity:20
Proximity card	capacity:50cards
Keys	2 Mechanical keys
Power supply	Standard 8.4V:lithium battery power supply with external power interface (Type C).

INSTRUCTION

6.1 Unlock from outside

6.1.1 Verify Administrator/User to unlock

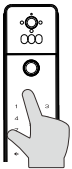

Password
Unlock

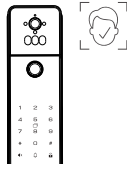

Face Recognition
Unlock

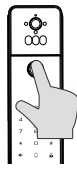

Fingerprint
Unlock

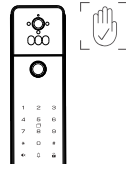

Palm Vein
Unlock

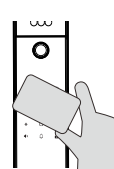

Proximity Card
Unlock



Dummy password function is supported, and the length of the password including the dummy password should not exceed 20 bits to completely eliminate the risk of peeping password.

6.1.2 Mechanical key unlocking

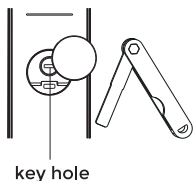

In case of emergency, such as forgetting the password, running out of battery power or system failure, a spare mechanical key can be used:

1. Push down and open the cover.
2. Insert mechanical key into the cylinder.
3. After the key is rotated it can be unlocked.

6.2 Lock from outside



Press the  can lock the door.

6.3 Unlock from inside

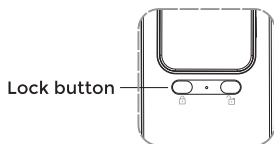

Press the lock button to lock

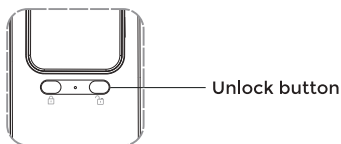

Press the unlock button to unlock

Note When Child mode is enable, Unlock button/Lock button become invalid

6.4 Emergency knob/Safety knob

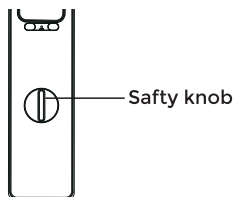

If the safety knob is used to lock, it cannot be opened from the outside in any way.

6.5 Wrong input freeze function



When the number of errors of face fingerprints, passwords and proximity cards within 5 minutes is 3 times in a row, an audible and visual alarm will be issued; when the number of errors is >5 times in a row, the system freezes for 120 seconds.

6.6 Battery level detection



When the battery voltage is lower than 6.8V there will be automatically alarm every time open the door. It still can be unlocking normally for 50 times. More than 50 times, unlock will be delayed for 5 seconds. Please replace battery before 50 times.

Note When prompted with a low battery, please charge it in time.

APP SETTING

7.1 Download the APP

Please search and download the "DNAKE SMART LIFE" APP from APP store.

7.2 Network pairing

7.2.1 Set on lock

Press "*" + admin information

Press 5: Network Setting

Waiting for network setting

7.3 APP operations

Method One

1. After enabling Bluetooth on your phone, select to add a device and wait for a while until the device is discovered.
2. Enter Wi-Fi (2.4G) information and wait for the device to pair.

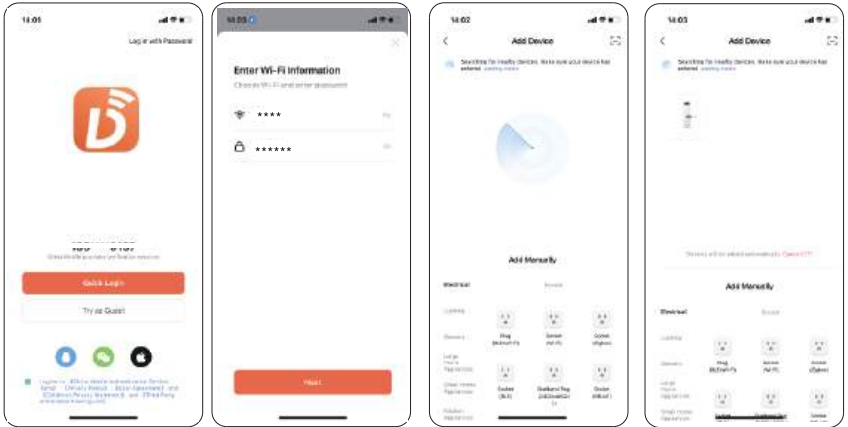

Method Two

1. Select the device.
2. Choose Video Lock (Wi-Fi).

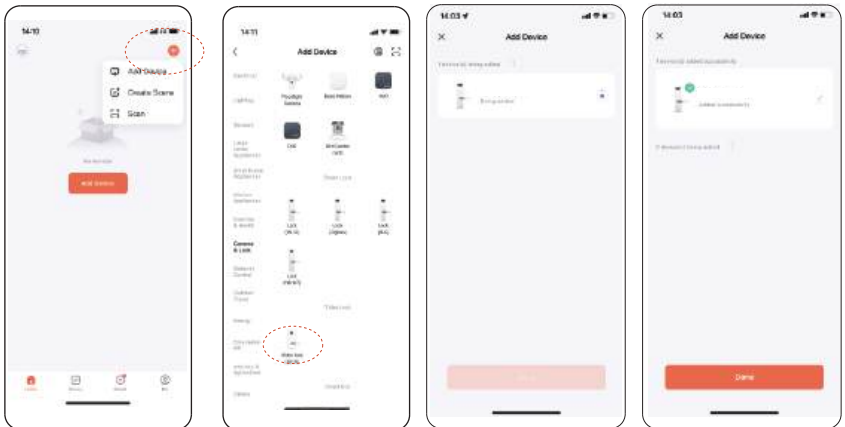

7.4 APP Instructions for User

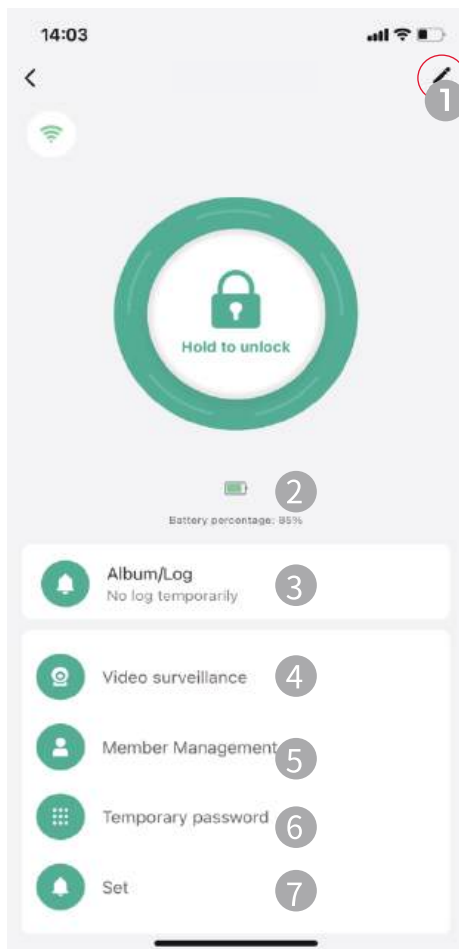

1. Device Management

Tap the icon in the upper right corner to access device settings or to remove the device.

2. Battery Display

Shows the real-time battery level of the lock.

3. Record Display

Displays alarm messages and operation logs, with each record timestamped.

4. Video Monitoring

In the active state of the door lock, you can view video and have two-way audio in real-time. The door lock is set to close the active mode by default when closed (for specific settings on active mode, refer to the section below).

5. Member Management

Add members to manage the door lock and associate them with relevant unlocking methods. You can also create new members and bind keys for

6. Temporary Passwords

Create various types of temporary passwords for temporary access.

7. Settings

More door lock settings.

Note The APP interface will be constantly updated, and the pictures are for reference only.

 **EASY & SMART
HOME SOLUTIONS**