

Datasheet

DNAKE IPK08

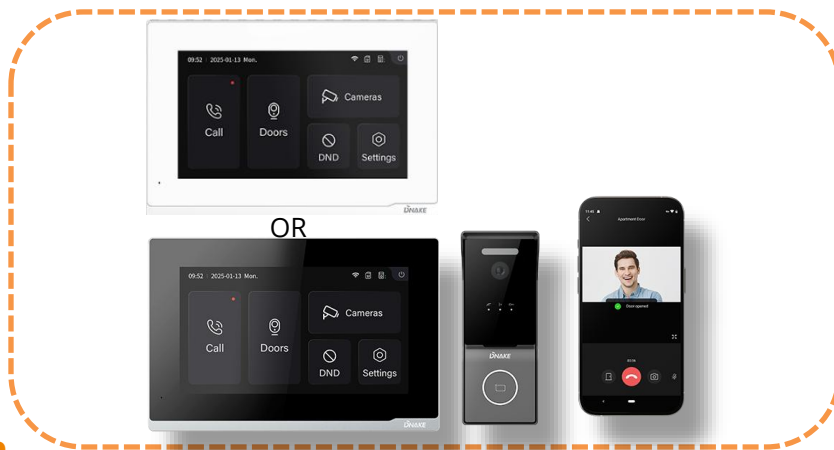

Instruction

Embrace security with a simple touch. DNAKE IP Video Intercom kit is a complete solution that includes a door station, an indoor monitor, and accessories to mount. The new IP intercom kit is immediately ready for use and does not require any special programming. Improve your safety at home while increasing convenience with DNAKE IP Video Intercom Kit!

Key Features

- Plug & Play
- 2MP HD digital WDR camera
- Multiple Unlock methods (Card,Temp Key, QR Code, APP, Indoor monitor)
- Check alarm notifications on the APP
- CCTV integration
- Extendable to 2 Door stations, 6 indoor Monitors

Package Features

- Package Content:
 - E217 (KIT) + C112R (KIT)
 - Brackets:2 pcs(indoor monitor and door station)
 - Screwing Kit
 - User Manual
- Qty/CTN: 9 Pcs
- N.W/PCS: 0.75 kg
- G.W/CTN: 10.35 kg
- Giftbox Size: 280 x 235 x 65 mm
- Carton Size: 625 x 300 x 260 mm



Datasheet

Key Features

- 7-inch capacitive touch screen
- Powered by PoE or DC12V
- Support SIP 2.0 protocol, easy integration with other SIP devices
- Support monitoring 8 IP cameras
- Support TF card

Physical

- Front Panel: Plastic
- System: Linux
- RAM: 128 MB
- ROM: 128 MB
- Power Supply: PoE (802.3af) or DC 12V/2A
- Standby Power: 2 W
- Rated Power: 9 W
- Ethernet Port: 1 x RJ45, 10/100 Mbps adaptive
- TF Card Slot: 1
- RS485: 1
- Power Output: 1 (12V/100mA)
- Doorbell Input: 8 (use any alarm input port)
- Alarm Input: 8
- Installation: Surface Mounting / Desktop
- Dimension: 195 x 130 x 21mm
- Working Temperature: -10°C to +55°C
- Storage Temperature: -40°C to +70°C
- Working Humidity: 10% to 90% (non-condensing)

DNAKE E217 (KIT)

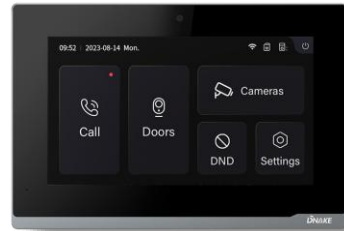

Display

- Display: 7-inch TFT LCD
- Screen: Capacitive touch screen
- Resolution: 1024 x 600

Audio

- Audio Codec: G.711
- Echo Cancellation
- DTMF: RFC2833
- Microphone: Built-in microphone
- Speaker: 8Ω / 1W

Video

- Video Codec: H.264

Networking

- Protocol: SIP, UDP, TCP, RTP, RTSP, NTP, DNS, HTTP, DHCP, IPV4, ARP, ICMP



Datasheet

DNAKE C112R (KIT)



Key Features

- Compact Design
- 2MP, 1080P HD Camera, digital WDR
- H.265 Video Codec
- Motion Detection
- IC card reader, Support 60,000 cards

Physical

- Front Panel: Plastic
- System: Linux
- RAM: 128 MB
- ROM: 128 MB
- Power Supply: PoE (802.3af) or DC 12V/2A
- Standby Power: 1.5 W
- Rated Power: 3 W
- Indicator Light: 3
- Wiegand Port: Support
- TF Card Slot: 1
- Ethernet Port: 1 x RJ45, 10/100 Mbps adaptive
- Door Entry: IC (13.56MHz) Card
- Reset Button: 1
- RS485 Port: 1
- Relay Out: 1
- Input: 2
- IP Rating: IP65
- Installation: Surface Mounting
- Surface Mounting DIM: 130 x 50 x 28 mm

- Working Temperature: -40°C to +55°C
- Storage Temperature: -40°C to +70°C
- Working Humidity: 10% to 90% (non-condensing)

Audio

- Audio Codec: G.711
- Echo Cancellation
- DTMF: RFC2833
- Microphone: Built-in microphone
- Speaker: Built-in speaker

Video

- Video Codec: H.264, H.265
- Video Resolution: 1920 x 1080
- Viewing Angle: 110° (H) / 60° (V) / 125° (D)
- Max. Image Transfer Rate: 1080p – 25fps
- Light Compensation: LED white light

Networking

- Protocol: ONVIF, SIP, UDP, TCP, RTP, RTSP, NTP, DNS, HTTP, DHCP, IPV4, ARP, ICMP

